



> Dutch-French ITER and Nuclear Industry Business Meeting

*June 28th-30th, 2009,
Utrecht - Delft, The Netherlands*





SUMMARY • French participation

ACC LA JONCHÈRE	4
AREVA	5
ASTRIUM SAS	6
BUREAU VERITAS	7
C2I, THE FRENCH ITER INDUSTRIAL COMMITTEE	8
CEA CADARACHE	9
COMEX NUCLÉAIRE	10
ESI GROUP	11
EURO CONTROLE PROJET	12
LOIRE INDUSTRIE	13
PHIMECA	14
PMB	15
WELCOME OFFICE FOR ITER COMPANIES	16
UBIFRANCE	17

ACC LA JONCHERE



Address: 5 rue des Ateliers
60200 COMPIEGNE - FRANCE

Ph.: +33 (0)3 44 38 66 66

Fax: +33 (0)3 44 38 66 77

Website: www.lajonchere.com

Contact: Pascal CAVALERI,
Directeur Commercial

Email: p.cavaleri@acc.fr

Global cost partnership of high pressure and high temperature ducts systems. Numerical simulation of forming process, non linear and linear analysis, flexibility calculations. Fabrication and assembly of rigid and articulated ducts with thermal insulation. Bellows, compensators, gimbals, metallic flexibles.

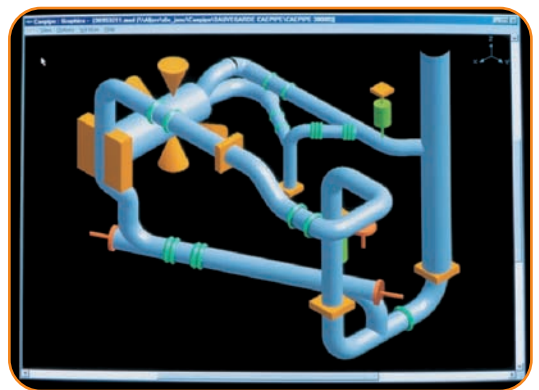

Address: 33 Rue Lafayette
75442 PARIS cedex 09 - FRANCE
Ph.: +33 (0)1 34 96 00 00
Fax: +33 (0)1 34 96 00 01
Website: www.areva.com

Contact: Antoine VERDIER,
New Builds Business Development
Director
Ph.: + 33 (0)1 34 96 85 18
Email: antoine.verdier@areva.com

All over the world, AREVA provides its customers with solutions for carbon-free power generation and electricity transmission. With its knowledge and expertise in these fields, the group has a leading role to play in meeting the world's energy needs.

Ranked first in the global nuclear power industry, AREVA's unique integrated offering covers every stage of the fuel cycle, reactor design and construction, and related services. In addition, the group is developing a portfolio of operations in renewable energies. AREVA is also a world leader in electricity transmission and distribution and offers its customers a complete range of solutions for greater grid stability and energy efficiency.

Sustainable development is a core component of the group's industrial strategy. Its 75,000 employees work every day to make AREVA a responsible industrial player that is helping to supply ever cleaner, safer and more economical energy to the greatest number of people.



Siège Social : 6 rue Laurent Pichat
75016 PARIS - FRANCE

Address for correspondence:

66 Route de Verneuil
78133 LES MUREAUX Cedex

Ph.: +33 (0)1 39 06 12 34

Fax: +33 (0)1 39 06 39 15

Website: www.astrium.eads.net

Contact: Pierre RUIBANYS,
Program Manager

Ph.: +33 (0)6 27 31 07 13

Email: pierre.ruibany@astrium.eads.net

Astrium is a wholly-owned subsidiary of EADS group (European Aeronautic Defence and Space Company). Astrium is the only company in Europe to master all techniques and technologies needed for space vehicles and associated operational ground support facilities. The business unit Astrium Space Transportation (Astrium-ST) designs, develops and produces military and civil launchers (Ariane5), main parts of European contribution propulsion systems and space equipments in a wide European industrial cooperation.

International presence :



ASTRIUM SYSTEMS PORTFOLIO:

ASTRIUM has an impressive product and capability portfolio as follows:

- launchers: Ariane, Soyuz, Rockot, Vega and future launchers;
- defense: Ballistic missiles, missile defense;
- orbital systems: Columbus, ATV, ISS Operations, Microgravity payloads, Re-Entry systems;
- propulsion & equipment;
- system design, system integration & production.
- ground installations for Ariane and Nuclear deterrent



All are large programs of systems with very high complexity...



BUREAU
VERITAS

Address: 37-39 Parc du Golf - CS 20512
13593 AIX-EN-PROVENCE - CEDEX 3
FRANCE

Ph.: +33 (0)4 42 37 25 00

Fax: +33 (0)4 42 37 24 50

Contact: Grégory REY,

Nuclear Project Manager

Ph.: +33 (0)6 47 94 22 95

Email: gregory.rey@fr.bureauveritas.com

Website: www.bureauveritas.com

Bureau Veritas was founded in 1828. Since that time it has grown to become a global leader in conformity assessment services in the areas of quality, health and safety, environment and social responsibility (QHSE).

As a result of a more than 12 years long growth, Bureau Veritas has generated in 2008 a revenue of 2.55 Bn and a adjusted operating profit of 388 M. This revenue is generated through a broad and balanced geographical presence.

We operate eight global businesses providing a complete set of services including: inspection, testing, audit, certification, classification, risk management, outsourcing, consulting and training services. We service 370,000 customers across a wide range of end markets.

Bureau Veritas is actively present in the nuclear market with worldwide partners: AREVA, WESTINGHOUSE, MHI, EDF, ESKOM, CEA, ENSA, ... We are present on the main nuclear projects (ITER, OL3, FA3, Georges Besse II, Atucha, ...)

Our local presence in the ITER project area in the South of France brings us responsiveness and we were awarded in tender on ITER impact assessment.

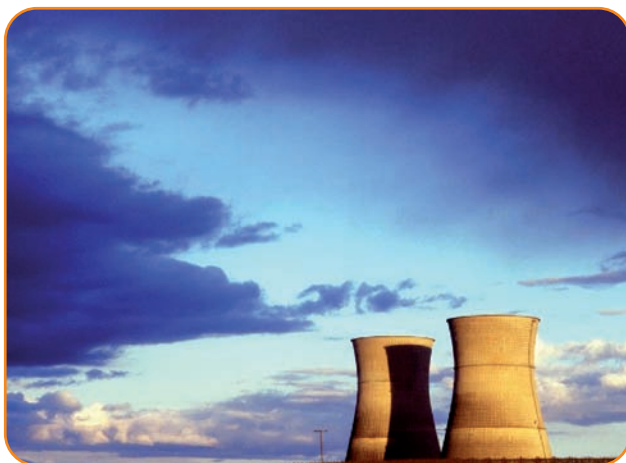

C2I, The French ITER Industrial Committee



Address: Préfecture de la Région
PACA / MISSION ITER
Immeuble Europrogramme
40, boulevard de Dunkerque
13002 MARSEILLE - FRANCE

Ph.: +33 (0)4 91 13 60 86

Fax: +33 (0)4 91 13 60 71

Website: <https://mioga.minefi.gouv.fr/ITER/public/SITE/>

Contact: Sabine PORTIER,
France Industrial Liaison Officer (ILO)

Email: mission-iter@paca.pref.gouv.fr

The French Industrial Committee for ITER (C2I) provides a Forum for pre-competitive networking and assimilation of ITER engineering & industrial requirements. Its mission is to involve French industrialists in the project and to organize optimal conditions for replying to future calls for tender.

The Committee brings together actors of 3 types:

- Industrial companies (Air Liquide, Areva, Alstom, Astrium Space Transportation, Cybernetix, CNIM, DCNS, Sagem Défense Sécurité, Schneider Electric, Siemens, Suez, Thalès, Technip ...), and professional associations or unions in the fields of engineering, mechanics, cryogenics, optics, electrical and electronics activities, robotics...
- Scientific Research and Industry clusters: CEA, 10 « Pôles de compétitivité » interested by ITER: Capenergies, Pôle Nucléaire Bourgogne, Pôle Optique-Photonique, Route des Lasers, MIPI, TRIMATEC, S2E2, ViaMeca...
- French national institutions and agencies (Ministry of the economy, finance and employment, Ministry of research and higher education, Oseo Innovation, Ubifrance and the Economic Missions Network...) and development agencies in the Provence-Alpes-Côte d'Azur (PACA) region.

Around 150 industrial members at present time.

4 main aims:

- Analyse specific technological requirements and opportunities for prime contractors and partnerships at European or international level
- Identify worldwide potential prime contractors and potential partners
- Promote industrial and scientific skills to mobilize on ITER project at national and regional level
- Identify specific needs of potential suppliers (connecting with suppliers or sub-contractors, with European or international partners, support in information - ITER procurement rules, schedule, codes & standards...- training) and specific concerns (contractual clauses, liabilities...)
- Present an industrial vision of the technological and management challenges for ITER.

Address: IRFM/DIR - Build. 513
13108 St Paul Lez Durance - FRANCE
Website: www.cea.fr

Contacts:
Gabriel MARBACH, Deputy Head of
Institute for Magnetic Controlled Fusion
Research
Email: gabriel.marbach@cea.fr
Ph.: +33 (0)4 42 25 70 01
Philippe LAVOCAT, Associate Director
of Physics Science Division
Email: philippe.lavocat@cea.fr
Ph.: +33 (0)1 69 08 46 55

General description:

CEA (Commissariat à l'Energie Atomique) is a French government-funded technological research organisation. The CEA is active in three main fields, Energy, information and health technologies, defence and national security. In each of these fields, the CEA maintains a cross-disciplinary culture of engineers and researchers, building on the synergies between fundamental and technological research. In 2007, the total CEA workforce consisted of 15612 employees.

Competence in fusion and nuclear relevant areas:

CEA-DSM-IRFM runs the TORE SUPRA Tokamak in Cadarache and participates in JET tokamak activities in England.

CEA is also strongly involved in ITER programme, Broader Approach activities and in EURATOM programme.

CEA is one key player in international nuclear activities participating in GEN- IV programme for safer future nuclear reactors.

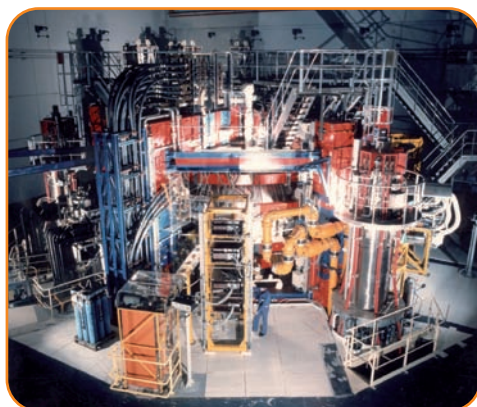

TORE SUPRA TOKAMAK



6 MINUTE LONG DISCHARGE
INSIDE TORE SUPRA

Address: 36 bd de l'Océan - CS20280
13258 MARSEILLE cedex 09 - FRANCE

Ph.: +33 (0)4 91 29 18 44

Fax: +33 (0)4 91 29 18 44

Website: www.comex-nucleaire.com

Contact: Denis MARTY,
Consultant Fusion Projects Director

Ph.: +33 (0)6 84 91 05 47

Email: dmarty@onet.fr

As the pioneering leader in severe environments, COMEX NUCLEAIRE is now involved in the entire lifecycle of complex nuclear and industrial facilities: Design and construction of nuclear facilities such as environmentally-regulated facilities (ICPE) and licensed nuclear facilities (INB); Maintenance and support for nuclear reactor and facility operators; Engineering and prime contracting of dismantling operations.

Advantages of COMEX NUCLEAIRE:

- Independent player and officially-recognised manufacturer capable of finding solutions to your design, maintenance and operational issues,
- Feedback from 20 years experience in nuclear reactor maintenance,
- Highly-specialised, cross-border engineering skills and proven nuclear expertise,
- Entrepreneurial culture guaranteeing responsiveness, flexibility and pragmatic technical solutions,
- Proven capacity for innovation and ability to improve maintenance methods to limit their duration, reduced occupational exposure, and optimised costs,
- A special unit devoted to making sure that nuclear pressure equipment regulations are being followed (known as the RESPN unit).

COMEX NUCLEAIRE is a subsidiary of ONET TECHNOLOGIES, one of the 4 divisions of the ONET Group.



Address: 100-102 Avenue de Suffren,
75015 PARIS - FRANCE

Ph.: +33 (0)1 41 73 58 00

Fax: +33 (0)1 46 87 72 02

Website: www.esi-group.com

Contact: Dr. L.T. KISIELEWICZ,
Executive Vice President Engineering
Systems

Ph.: +33 (0)1 41 73 58 31

Email: tki@esi-group.com

ESI Group is a world leading software editor for the numerical simulation of prototype and manufacturing process engineering in applied mechanics. The key to ESI Group's success is the use of realistic material physics, providing "as good as real" virtual solutions, in order to replace the lengthy trial and error processes on real prototypes.

ESI Group has developed an extensive suite of coherent, industry-oriented applications to realistically simulate a product's behavior during testing, to fine-tune manufacturing processes in accordance with desired product performance, and to evaluate the environment's impact on product performance.

ESI Group's products, associated with high value added services, represent a unique collaborative and open environment for Simulation-Based Design, enabling virtual prototypes to be improved in a continuous and collaborative manner while eliminating the need for physical prototypes during product development.

The company employs over 750 high-level specialists worldwide covering more than 30 countries. As ESI Group development is based on continuous innovation; the company is qualified as "innovative company" by OSEO, a French innovation agency.

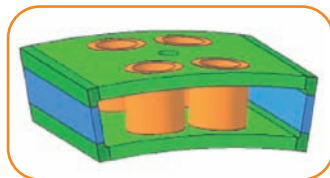
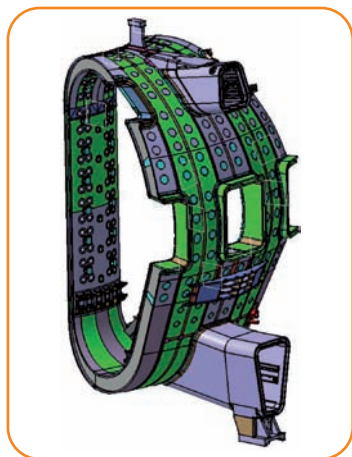

VEF mock-up lodelfor optimizing welding sequence to minimize distortions. Welding was simulated with full physics along all the line welds in sequence.



EURO CONTROLE PROJET



Address: Les portes de l'Arbois - Bat. B
1090, Rue René Descartes
13857 AIX EN PROVENCE - Cedex 3
FRANCE
Ph.: +33 (0)4 42 90 41 41
Fax: +33 (0)4 42 90 41 42
Website: www.ecprojet.fr

Contact: Jean-Claude HIPPOMENE,
Nuclear/Defense Business Unit Manager
Ph.: +33 (0)6 87 97 11 94
Email: jc.hippomene@ecprojet.fr

ECP (Euro Contrôle Projet) is an independent consulting company whose head quarters are in France. Based on 20 years of experience, it offers all or part of the services for Project Management, Design, Cost Estimating, and Control, Schedule and Progress monitoring, Risks Assessment and management, Procurement, Contract and Subcontract Management, Document Control, Quality Management and Construction, Supervision, Hook-up and Commissioning.

ECP has proven track record in Project Management Consultancy projects, in particular in the Energy sector (Nuclear, Oil and Gas...), and is in a position to fulfill the expectations of clients wishing to entrust a large range of services to a single company able to assist them in their project development and implementation.

ECP's range of services is divided into several main poles: Project Management Consultancy (PMC), Expertise, Consulting, Training, Technical Assistance.

" Coming together
is a beginning.
Keeping together
is progress.
Working together
is success. "

Henry Ford



Address: ZI le Clos Marquet
42406 ST CHAMOND - FRANCE
Ph.: +33 (0)4 77 29 20 00
Fax: +33 (0)4 77 22 63 21
Website: www.loire-industrie.fr

Contacts:
Katia DURIEUX
Phone: +33 (0)4 77 29 20 01
Email: katia.durieux@loire-industrie.fr
Marc BEAUDET
Ph.: +33 (0)4 77 29 77 99
Email: marc.beaudet@loire-industrie.fr
Thierry LE GOFF
Ph.: +33 (0)4 77 29 20 18
Email: thierry.legoff@loire-industrie.fr

Since many years, LOIRE INDUSTRIE is involved in the Nuclear Power Industry thanks to its know how. To answer these specific queries, LOIRE INDUSTRIE has implied all its employees to adopt the Safety Culture.

Realized Projects:

AREVA NP (France) - 2005 OLKILUOTO 3 PROJECT (EPR Finland): Flanges and round bars
AREVA NP (France) - 2008 FLAMANVILLE 3 PROJECT (EPR France): Forged connexion parts and round bars
AREVA NP (France) - 2007 AREVA LYON : Flanges
FLOWSERVE USA - 2007/2008 LINGAO PROJECT CHINA: Round Bars
FLOWSERVE USA - 2006/2007 OLKILUOTO 3 PROJECT USA: Round Bars

And other references:

UNION PUMP (OLKILUOTO 3 EPR and FLAMANVILLE 3)
WEIR VALVES (OLKILUOTOT 3 EPR)
ENDEL BOCCARD (FLAMANVILLE 3 EPR)
PONTICELLI (FLAMANVILLE 3 EPR)
ADF (FLAMANVILLE EPR)

LOIRE INDUSTRIE is also the manufacturer of flanges, forged and ring rolled pieces from 1 kg to 6000 kg in different steel grades (carbon, stainless, alloy, low temperature...steels).

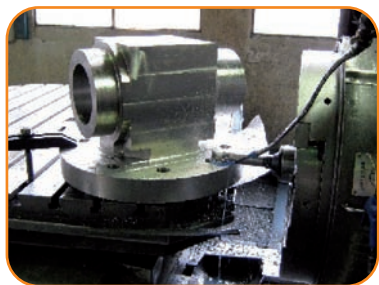

Address: Centre d'Affaires du Zénith
34 rue de Sarliève
63800 COURNON D'AUVERGNE
FRANCE
Ph.: +33 (0)4 73 28 93 66
Fax: +33 (0)4 73 28 95 78
Website: www.phimeca.com

Contact: Dr. Thierry YALAMAS,
Project Manager
Ph.: +33 (0)1 58 51 18 02
Email: yalamas@phimeca.com

The PHIMECA company is a SME created in 2001. From its strong experience in mechanical engineering and a close link with academic research, PHIMECA aims at being a European leaders in structural reliability analyses and more generally, in the assessment of uncertainties in engineering systems.

The activity consists on systems engineering, scientific computer science, expertise in numerical simulations, reliability and management of uncertainties, statistical and probabilistic approaches R&D, scientific and technical training sessions, development and marketing of uncertainty softwares (Phimeca Soft, Open Turns, ...)

Based on statistics, probability theory and optimization procedures, structural reliability methods allow practitioners to control the design of their systems by evaluating the probability of safe design and estimating safety margins. To this aim, PHIMECA develops cutting-edge methodologies in close cooperation with the academia through jointly supported research projects and PhD theses, whose results are eventually integrated in a dedicated software, namely PhimecaSoft.

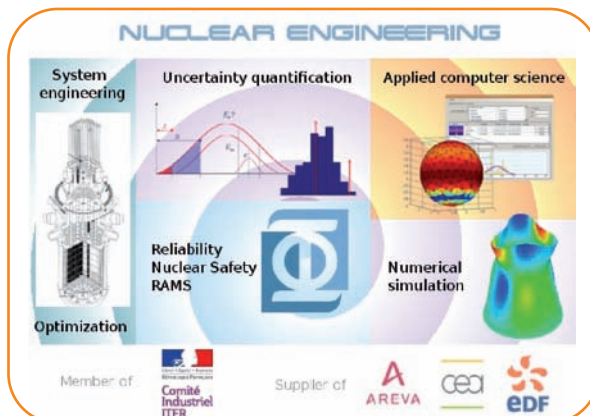

Address: Route des Michels - CD56
Lieu dit « La Corneirelle »
13790 PEYNIER - FRANCE
Ph.: +33 (0)4 42 53 13 13
Fax: +33 (0)4 42 53 30 83
Website: www.pmb-alcen.com

Contact: Dirk FOCKE,
Project Manager
Ph.: +33 (0)4 42 53 53 67
GSM: +33 (0)6 89 10 36 79
Email: dfocke@pmb-alcen.com

PMB offers research and design services, prototyping, small to medium quantities production, testing and UHV cleaning of components enduring harsh environments. Starting with selection of the raw materials, PMB shapes ceramics (alumina, sapphire, zirconia, etc.) and metal (Beryllium, copper, stainless steel, titanium, ferrous and non-ferrous alloys,...) by the means of molding, sintering, grinding, machining, forming, straightening, etc...to assemble your components and subassemblies by brazing at low and high temperature under vacuum or in a controlled atmosphere, by welding or any other assembly methods. Being ISO 9001 certified we assure the traceability all along the production loop. Our team of process engineers vouches for global involvement in our lean manufacturing process. PMB's test facilities are equipped to perform non-destructive and destructive testing, electrical, pressure, temperature and mechanical tests. The quality department deals with the required procedures, quality plans, production qualification files, end of fabrication deals and other needs for the Nuclear and scientific markets. PMB's proximity to Cadarache and our international experience are major added values for a future collaboration.



WELCOME OFFICE FOR ITER COMPANIES



Address: 22 rue Sainte Barbe, BP 32064
13203 MARSEILLE cedex 1- FRANCE

Ph.: +33 (0)4 96 17 07 40

Fax: +33 (0)4 91 90 01 58

Website: www.mder-paca.com

Contacts:

Renaud ROUQUETTE

Email: renaud.rouquette@mde04.com

Ph.: +33 (0)6 89 40 78 80

Michaël DENIS

Email: m.denis@adev-84.com

Ph.: +33 (0)6 89 70 77 30

Cyril DARY

Email: cdary@teamcotedazur.fr

Ph.: +33 (0)6 26 31 21 37

The network of economic development partners in Provence-Alpes-Côte d'Azur region supports companies that have an interest in the ITER project with confidential and free assistance during all the steps of their development.

They work together to provide the best service possible to investors considering relocating or expanding operations near the ITER project.

The choice of Provence-Alpes-Côte d'Azur in the South of France as the key site of the ITER project confirms its reputation as one of the most attractive, economically dynamic regions in Southern Europe.

A network of economic development agencies who work to support your investment in Provence-Alpes-Côte d'Azur represent the Welcome Office for ITER Companies (WOIC).

In order to help companies to set up near the Iter site, the WOIC provides, free of charge:

- o Assistance with context analysis: French legal and tax matters (potential suppliers, clients, R&D, laboratories, special training), market statistics, customized information by sector, cost simulating salaries, public funding, set up costs...).

- o Set up support: assistance in finding available offices and the necessary equipment or furniture, organization of investors' pools and assistance with obtaining public funding, assistance for recruitment and facilitating administrative procedures.

- o Development support: introduction to private and public networks (business clubs, competitive clusters...), assistance with identifying and contacting potential partners, based on needs.



UBIFRANCE

**The French Agency for International
Business Development**

Website: www.ubifrance.fr

Head Office in Paris

Energy-Environment Department

77 Boulevard Saint-Jacques

75014 PARIS - FRANCE

Ph.: +33 (0)1 40 73 39 07

Fax: +33 (0)1 40 73 31 02

Contact: Carole CUNISSET,
Head of Department

Office in Marseilles

2 Place d'Arvieux, BP 60708

13572 MARSEILLE Cedex 02 - FRANCE

Ph.: +33 (0)4 96 17 25 34

Fax: +33 (0)4 96 17 68 17

Contact: Emmanuel GALLAND,
Project Manager Nuclear Industry

E-mail: emmanuel.galland@ubifrance.fr

The Economic Mission the Hague

FRENCH EMBASSY IN THE NETHERLANDS

Website: www.dgtpe.fr/se/pays-bas

Head Office in Paris

French Embassy - Economic Department

Koninginnegracht 14A

2514 AA The Hague

Ph.: +31 70 356 66 35

Fax: +31 70 346 67 95

Contact: Anne-Brigitte MASSON
Economic Attaché

E-mail: anne-brigitte.masson@missioneco.org

Contact: Jaap van der MAREL
Commercial Attaché

E-mail: jaap.vandermarel@missioneco.org

From September 09,

the Economic mission will move to
Amsterdam. More information and new
address : www.dgtpe.fr/se/pays-bas

Supporting companies in their international development.

Main operational activities:

- to provide information and assistance to companies seeking to exportation
- to promote French expertise, products and technologies (trade fairs, etc...)
- to help with export financing
- to help companies setting up abroad



UBIFRANCE
ET LES
MISSIONS ÉCONOMIQUES